

PRESENTATION – PRÉSENTATION – ANSICHT

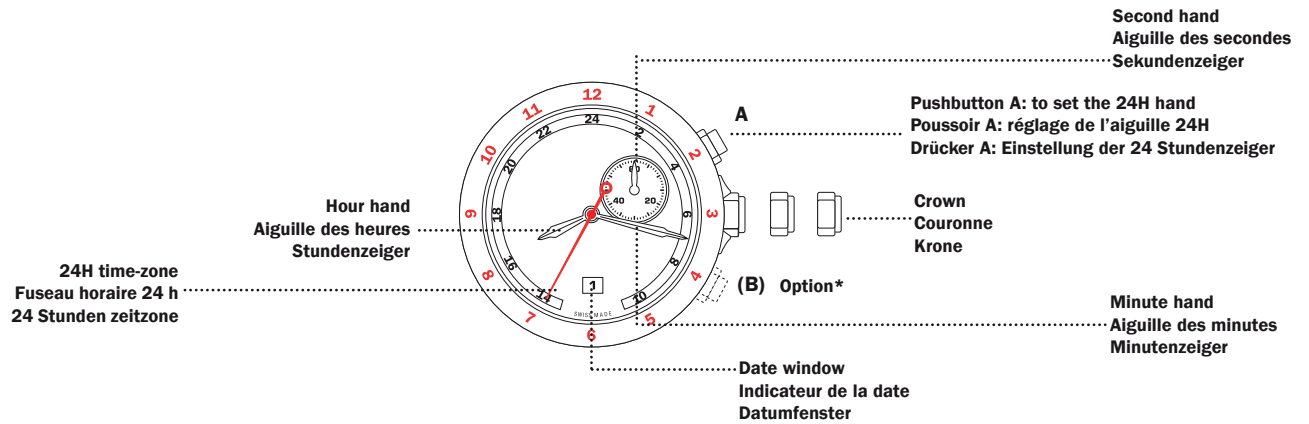

**SETTING THE TIME
HOUR AND MINUTE**

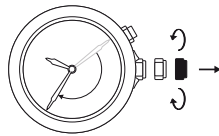

0.1

**REGLAGE DE L'HEURE
ET MINUTE**

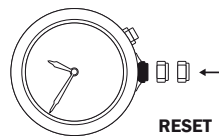

0.2

RESET

**EINSTELLEN DER ZEITANZEIGE
STUNDEN UND MINUTEN**

**SETTING THE DATE
CAUTION: NEVER CORRECT DATE
BETWEEN 9 PM AND 0.30 AM.**

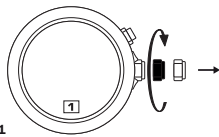

1.1

**CORRECTION DE LA DATE
ATTENTION: LA CORRECTION
DE LA DATE NE PEUT PAS
SE FAIRE ENTRE 21H00 ET 0H30.**

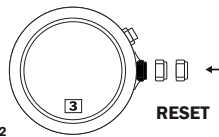

1.2

RESET

**EINSTELLEN DES DATUMS
ACHTUNG: DATUM NICHT
ZWISCHEN 21 UHR UND 0 UHR
30 EINSTELLEN.**

2nd TIME ZONE

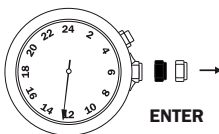

2.1

2eme FUSEAU HORAIRE

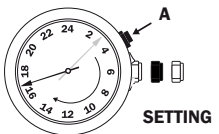

2.2

SETTING

ZWEITE ZEITZONE



2.3

OFF

Option*: Possibility of replacing pushbutton A by pushbutton B
Option*: Possibilité de remplacer le poussoir A par le poussoir B
Option*: Möglichkeit den drücker A mit dem drücker B zu ersetzen

8176 / 2050

PRESENTATION – PRESENTAZIONE – PRESENTACION

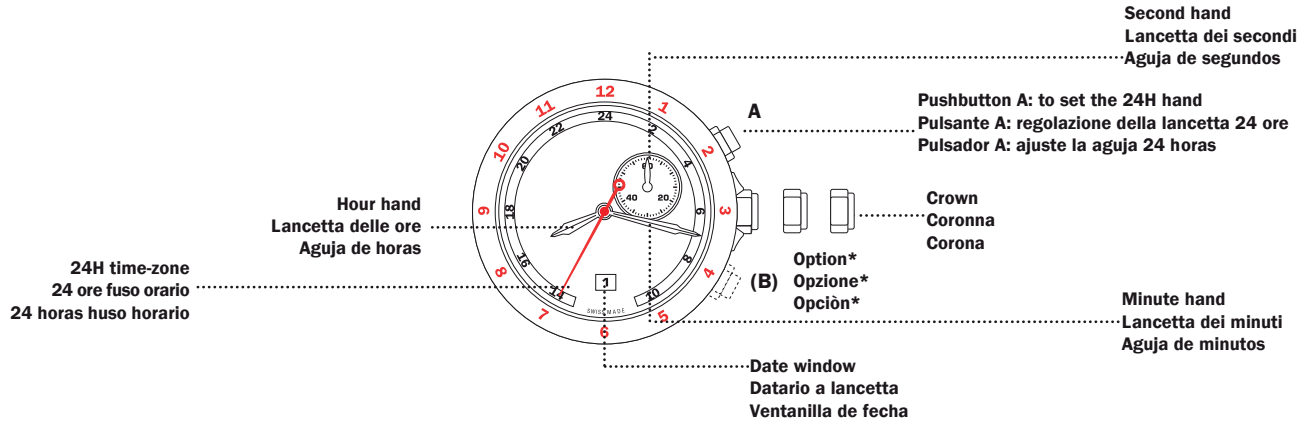

SETTING THE TIME
HOUR AND MINUTE

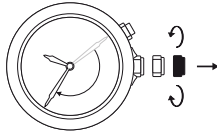

CORREZIONE DELL'ORA
E MINUTI

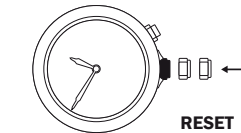

AJUSTE HORA Y
MINUTO

SETTING THE DATE
CAUTION: NEVER CORRECT DATE
BETWEEN 9 PM AND 0.30 AM.

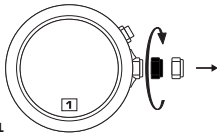

CORREZIONE DELLA DATA
ATTENZIONE: IL CAMBIO DI
DATA NON È POSSIBILE DALLE
ORE 21 ALLE ORE 0.30.

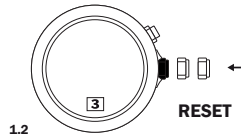

AJUSTE DE LA FECHA
ATTENCIÓN: NO SE PUEDE
CAMBIAR LA FECHA
ENTRE LAS 21H Y 0H30.

2nd TIME ZONE

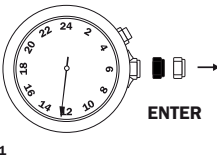

2o FUSO ORARIO

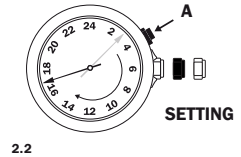

2o HUSO HORARIO

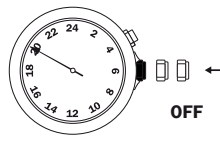

Option*: Possibility of replacing pushbutton A by pushbutton B
Opzione*: Possibilità di sostituire pulsante A per pulsante B
Opción*: Posibilidad de sustituir pulsador A por pulsador B